

AIRCRAFT PARKING /
DOCKING CHART - ICAO

APRON ELEV 12 m

TWR 118.25 118.85 321.025
GND 121.7 317.45

MUAN / Muan Intl

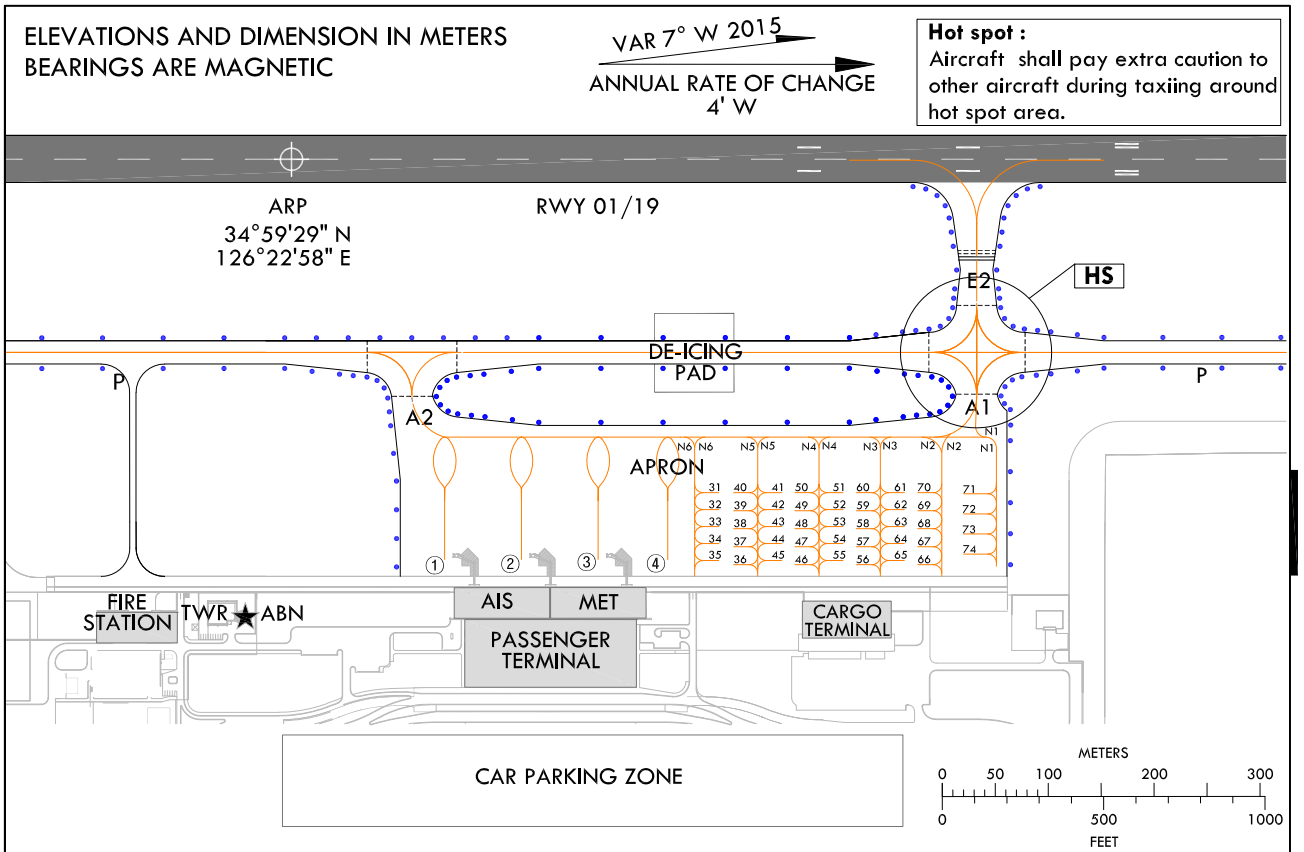

STANDS NR	INS COORDINATES FOR AIRCRAFT STANDS(WGS-84)	ELEV(AMSL)	STANDS NR	INS COORDINATES FOR AIRCRAFT STANDS(WGS-84)	ELEV(AMSL)
1	34°59'33.83" N 126°23'13.00" E	11.44	58	34°59'46.34" N 126°23'11.81" E	11.89
2	34°59'36.18" N 126°23'12.99" E	11.53	59	34°59'46.34" N 126°23'11.14" E	11.84
3	34°59'38.53" N 126°23'12.97" E	11.54	60	34°59'46.33" N 126°23'10.47" E	11.90
4	34°59'40.27" N 126°23'13.01" E	11.82	61	34°59'47.81" N 126°23'10.46" E	11.99
31	34°59'42.13" N 126°23'10.51" E	11.68	62	34°59'47.81" N 126°23'11.09" E	11.94
32	34°59'42.13" N 126°23'11.14" E	11.65	63	34°59'47.81" N 126°23'11.72" E	12.00
33	34°59'42.13" N 126°23'11.77" E	11.74	64	34°59'47.82" N 126°23'12.35" E	12.05
34	34°59'42.14" N 126°23'12.40" E	11.81	65	34°59'47.82" N 126°23'12.98" E	12.11
35	34°59'42.14" N 126°23'13.03" E	11.89	66	34°59'48.23" N 126°23'13.14" E	12.16
36	34°59'42.57" N 126°23'13.19" E	11.93	67	34°59'48.23" N 126°23'12.47" E	12.07
37	34°59'42.57" N 126°23'12.52" E	11.85	68	34°59'48.22" N 126°23'11.80" E	12.01
38	34°59'42.56" N 126°23'11.85" E	11.76	69	34°59'48.22" N 126°23'11.13" E	11.96
39	34°59'42.56" N 126°23'11.18" E	11.67	70	34°59'48.22" N 126°23'10.46" E	12.01
40	34°59'42.56" N 126°23'10.51" E	11.70	71	34°59'49.64" N 126°23'12.74" E	12.20
41	34°59'44.03" N 126°23'10.49" E	11.78	72	34°59'49.63" N 126°23'11.99" E	12.13
42	34°59'44.03" N 126°23'11.13" E	11.72	73	34°59'49.63" N 126°23'11.24" E	12.06
43	34°59'44.04" N 126°23'11.76" E	11.80	74	34°59'49.63" N 126°23'10.49" E	12.10
44	34°59'44.04" N 126°23'12.39" E	11.88			
45	34°59'44.04" N 126°23'13.02" E	11.95			
46	34°59'44.47" N 126°23'13.17" E	11.97			
47	34°59'44.46" N 126°23'12.49" E	11.89			
48	34°59'44.46" N 126°23'11.83" E	11.80			
49	34°59'44.46" N 126°23'11.16" E	11.73			
50	34°59'44.45" N 126°23'10.48" E	11.79			
51	34°59'45.93" N 126°23'10.47" E	11.88			
52	34°59'45.93" N 126°23'11.10" E	11.82			
53	34°59'45.93" N 126°23'11.74" E	11.87			
54	34°59'45.93" N 126°23'12.37" E	11.93			
55	34°59'45.94" N 126°23'13.00" E	12.02			
56	34°59'46.35" N 126°23'13.15" E	12.10			
57	34°59'46.35" N 126°23'12.48" E	11.97			

RWY	THR coordinates(WGS-84)	BEARING	STRENGTH
01	34°58'44" N 126°22'58" E		PCN 78/F/C/X/T ASPHALT
19	35°00'14" N 126°22'58" E		

Taxiway width, strength and surface	TWY	WIDTH	Strength and Surface
	P	23 m	PCN 81/R/C/W/T CONCRETE
	E1	28 m	
	E2	33 m	
	E3	28 m	
	A1	39 m	
	A2	40 m	
G	23 m	PCN 32/R/C/W/T CONCRETE	

STANDS NR	STAND AVAILABILITY
1 to 2	B747-400, B777-200
3	B767-400, B767-300
4	B737-900, A321-200
31 to 70	DA42, PA34
71 to 74	C208B, CARV - II

LEGEND	
•	Taxiway light
≡≡≡	Runway holding position
---	Intermediate holding position
A1	Taxi way
①	Aircraft Stand
→	Taxi routes
○-HS	Hot spot

TAXIWAY EDGE LIGHTS ON ALL TAXIWAYS.
*ISOLATED AREA : At the intersection of TWY E2 and TWY A1

Change : Information of ACFT stands number and Establishment of TWY G.